

SWH30L100Txx-28-10BD

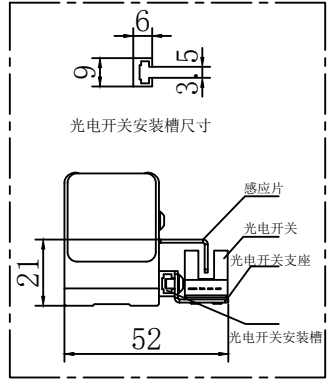

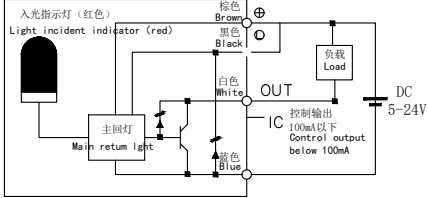

感应器接线图
Sensor wiring diagram

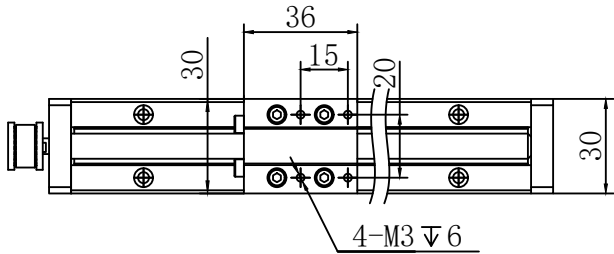
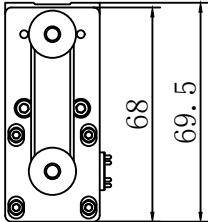
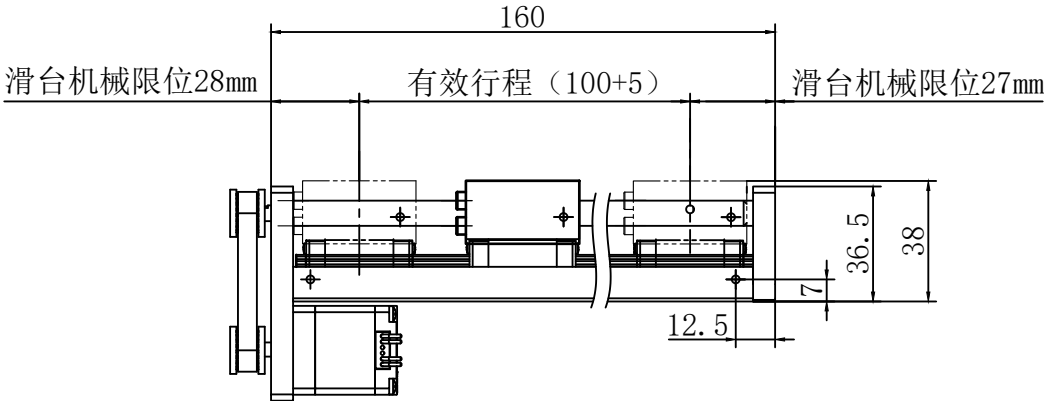
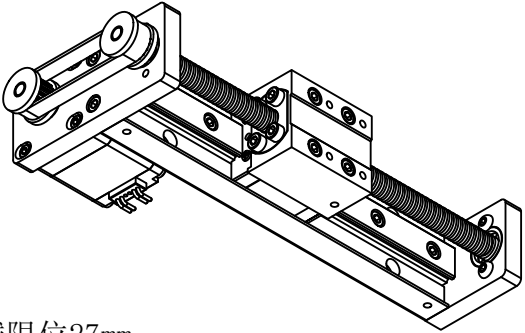
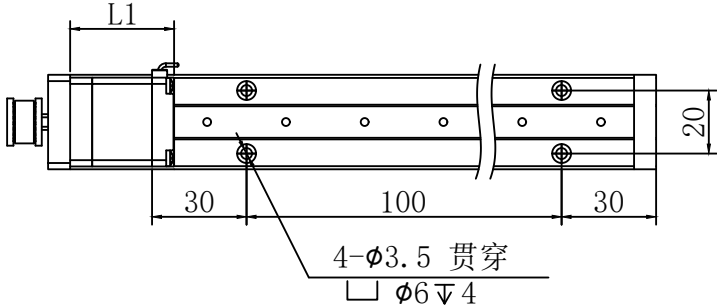

光电开关选配件



特性 character	规格 specifications
1. 导程 The guide	2/4/8
2. 步距角 Step Angle	1.8°
3. 保持转矩 Holding Torque	≥-- mN.M
4. 搭配马达 Pair with a motor	步进28
5. 加速度 acceleration	100ms (0.2s)
6. 重复定位精度 positioning accuracy	±0.05mm
8. 额定电流 Rated current	DC 0.67A
9. 传感器 (选配) sensor	(NPN)+1米线
10. 重量 weight	0.8 kg
11. 绝缘等级 Insulation class	B Class

表面粗糙度					
图面为标示一般公差	游标尺公差300以下±0.5 孔距公差±0.15, 方格公差±0.015				
量 尺 公 差	300以下±0.5 300~600±0.7 600~1000±1.0 未标示之倒角C0.5, 未标示之圆角R0.5				
表面处理	热处理		材质		

UMot		视图 view		重庆优摩特科技有限公司 Chongqing UMot technology Co.Ltd.			
		比例 inverse proportion	1:1				
		A1					
设计 INSPECTED	审核 CHECKED	批准 APPROVED	日期 Date	版本 Version	型号 Model	SWH30L100Txx-28-10BD	

可选电机高度 (L1)	32.5	40	52
客户选型打 \checkmark			